

DESIGNER SERIES COLLECTION

DESIGNER SERIES 5 35CM

BASIN 1TH



*Tap not included

Product Code	DS535BA1BX
Weight (Kg)	6.3
Material	Fireclay
Tap holes	1
Fixings	Not included
Extras	Bottle Trap - BOTRAPCH

Key features:

- CE Compliant
- Chrome effect overflow ring
- Internal overflow
- Lifetime ceramic guarantee*

Description:

This is in! These thin lipped contemporary basins are made using the latest technology, our designers have crafted beautiful basins with smooth lines and sharp minimal profiles. Not suitable for use with full or semi pedestal.

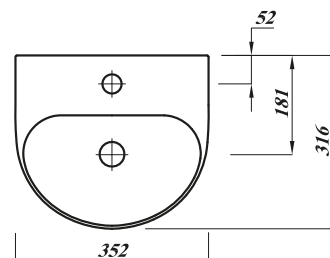
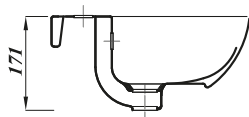
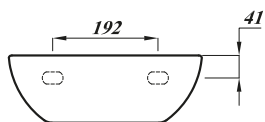

All dimensions are approximate and subject to normal ceramic variation. Although every effort is made not to change the above product specification, Lecico reserve the right to do so without prior notification if necessary. *Against manufacturers defects. Full information on guarantees available upon request.