

## Geberit bathtub drain with turn handle and inlet, d52, length 23 cm, with ready-to-fit-set and straight connector

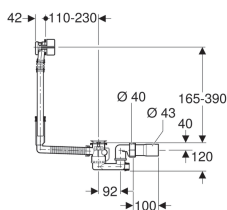

Example image



### Application purposes

- For bathtubs made of steel, plastic or cast iron
- For standard-size bathtubs
- For bathtubs with valve hole  $\varnothing$  52 mm

### Characteristics

- Quality-monitored in accordance with EN 274-3
- With overflow and inlet
- Inlet jet can be aligned
- Double-sided seals on drain and overflow
- Overflow head with extendible mount can be fastened

### Technical data

|                         |          |
|-------------------------|----------|
| Line noise at 3 bar     | 15 dB(A) |
| Sound class             | 1        |
| Inlet capacity          | 0.35 l/s |
| Discharge rate          | 0.85 l/s |
| Overflow discharge rate | 0.6 l/s  |
| Depth of water seal     | 50 mm    |

### Scope of delivery

- Waste outlet
- Trap
- Overflow head with inlet
- Elbow tap connector 90° with male thread G 3/4" and Euro cone  $\varnothing$  20 mm, rotatable
- Straight connector made of PE-HD,  $\varnothing$  43 mm
- Ready-to-fit set
- Protection box
- Fastening material

| Art. no.     | Surface / colour    |
|--------------|---------------------|
| 150.712.21.1 | gloss chrome-plated |

### Accessories

- Geberit connection set for bathtubs made of acrylic, with overflow