

Urinal Duravit Rimless® 0,5 L # 280930..00 / 280930..07

| < 300 mm > |

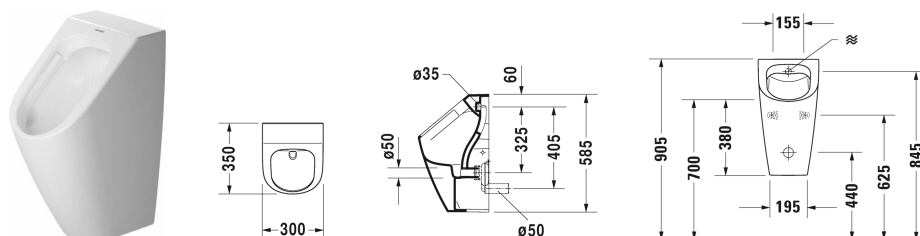

| Urinal Duravit Rimless® 0,5 L | Dimension | Weight | Order number |
|--|--------------|-----------|--------------|
| rimless, concealed inlet, syphonic action, horizontal outlet, fixings included | | | |
| Colors | | | |
| 00 White Alpin 20 HygieneGlaze (an antibacterial ceramic glaze that provides almost indefinite effectiveness) | | | |
| Variant | | | |
| model without fly | 300 x 350 mm | 19.100 kg | 280930..00 |
| model with fly | 300 x 350 mm | 19.100 kg | 280930..07 |
| Infobox | | | |
| Siphon 0051130000 is required | | | |
| Sanitary ceramics with the special WonderGliss surface finish will remain clean and attractive-looking for a long time to come. When ordering WonderGliss please add a "1" as eleventh digit to the model number. | | | |
| Accessory | | | |
| Urinal screen | | 0.200 kg | 005042 |
| Water inlet mechanism for urinals with back supply | 1/2" mm | 0.100 kg | 695800 |
| Siphon horizontal outlet (concealed) | ø 50 mm | 0.200 kg | 005113 |

All drawings contain the necessary measurements which are subject to standard tolerances. Exact measurements, in particular for customised installation scenarios, can only be taken from the finished ceramic piece.