

Bathtub with support feet (for standard installation) # 700030000000000

| < 1800 mm > |

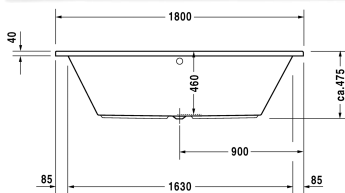
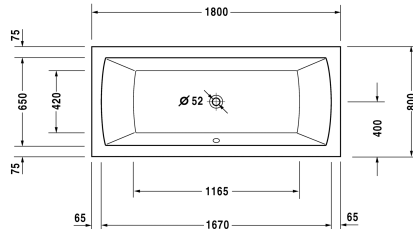

Bathtub with support feet (for standard installation)	Dimension	Weight	Order number
rectangle, built-in, sanitary acrylic , Filling capacity 185 l			
Colors			
00 White Alpin			
Variant			
Basic model	1800 x 800 mm	35.200 kg	700030000000000
Suitable setting			
LED coloured light with remote control for bathtubs, (white -00, chrome -10)			790840
Suitable products			
Bathtub anchors for mounting and support of bathtubs and shower trays, 3 pieces,			790103
Rubber profile for noise reduction, length: 3300 mm,			790104
Tub cover, 2 pcs. 800 x 450 mm, for Darling New # 700244, Daro # 700028, D-Code # 700101, Happy D.2 # 700314, Vero # 700135, Vero Air # 700413, 700415, 700416, 700417,			791828
Tub cover with cut-out for hand shower tube, 2 pcs. 800 x 450 mm, for Darling New # 700244, Daro # 700028, D-Code # 700101, Happy D.2 # 700314, Vero Air # 700413, 700415, 700416, 700417,			791829
Waste and overflow Quadroval chrome, for bathtubs with central outlet, outlet diameter 52 mm, length of bowden cable 650 mm,			790289
Waste and overflow Quadroval with water inlet, chrome, *, for bathtubs with central outlet, outlet diameter 52 mm, length of bowden cable 650 mm,			790290

Bathtub with support feet (for standard installation) #
7000300000000000

|< 1800 mm >|

Noise reduction set for acrylic bathtubs ****, Contents: noise
protection bathtub anchors, bitumen pads, rubber profile #
790104,

791368

All drawings contain the necessary measurements which are subject to standard tolerances. Exact measurements, in particular for customised installation scenarios, can only be taken from the finished ceramic piece.